

DO NOT SCALE FROM THIS DRAWING
 ASK FOR DIMENSION
 USE ONLY FOR PURPOSE
 INDICATED BELOW

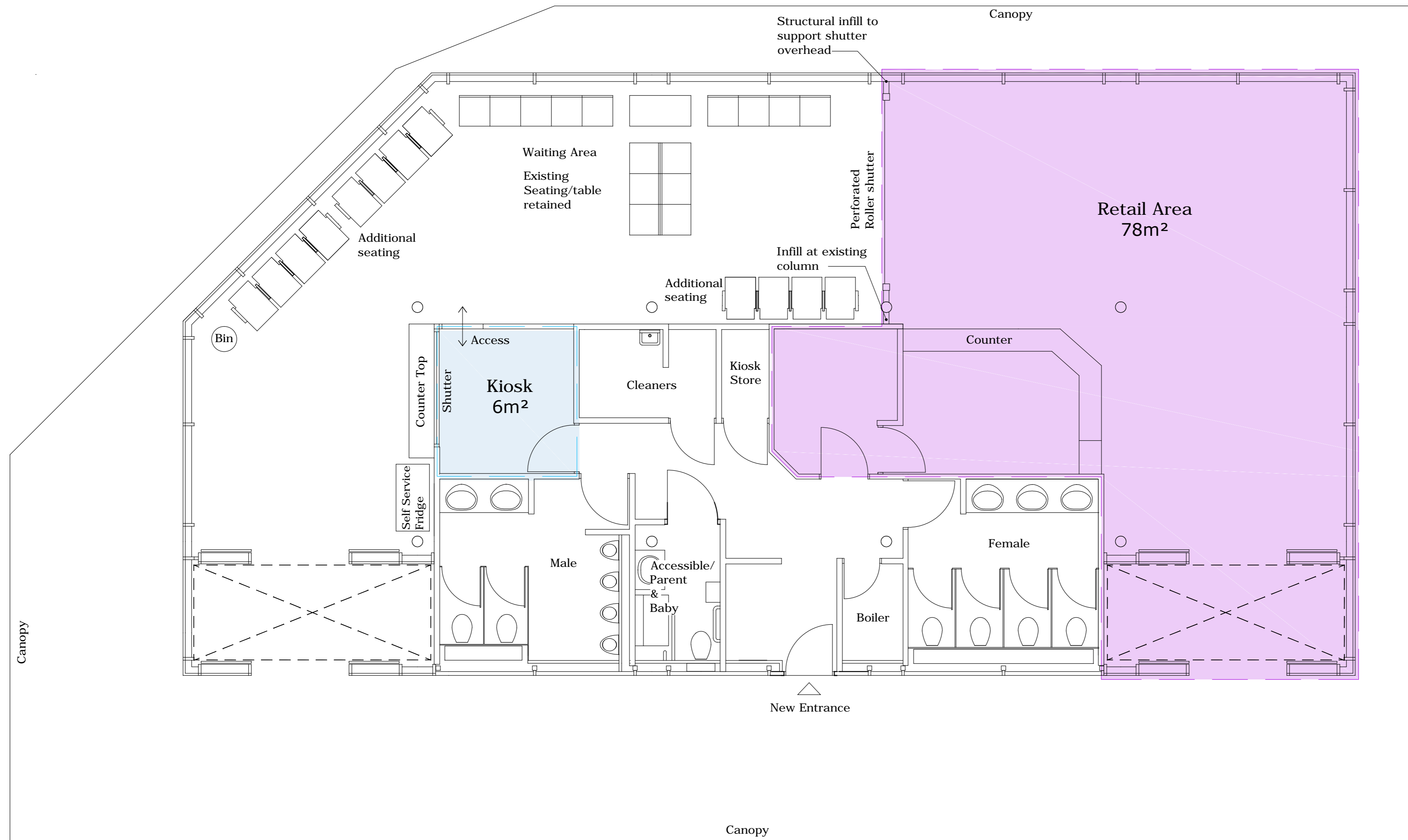

Notes

1. Lighting and suspended ceiling to be renewed.
2. All IT & Light Controls to be moved out of Kiosk.
3. Intruder System renewed to suit.
4. New CCTV.
5. Consideration of fire separation required.
6. Access doors to be reconfigured.
7. Consideration of electrical alterations required.
8. Consideration of kiosk fit-out required.

REVISIONS	
A	AMENDMENT TO SEATING ARRANGEMENT
B	AMENDMENT TO SEATING ARRANGEMENT

Forest Heath • St Edmundsbury

West Suffolk
working together

WEST SUFFOLK PROPERTY SERVICES

Head of Service Mark Walsh

West Suffolk House Tel: 01284 763233
 Western Way, Bury St. Edmunds, Suffolk, IP33 3YU Fax: 01284 757386
 E-Mail: property.services@westsuffolk.gov.uk

Project: **Bus Station BSE**

Title: **Proposed Floor Plan**

Scale: 1:50	Drawing Size: A2
Date: 14 APR 15	Drawn By: KLS
Appr By: [Signature]	Revision: B

File No.: Drawing No.: 002

Proposed Floor Plan
 Scale 1:50